

PLEASE OPERATE ACCORDING TO THE MANUAL BEFORE YOU FLY

## Instruction Manual

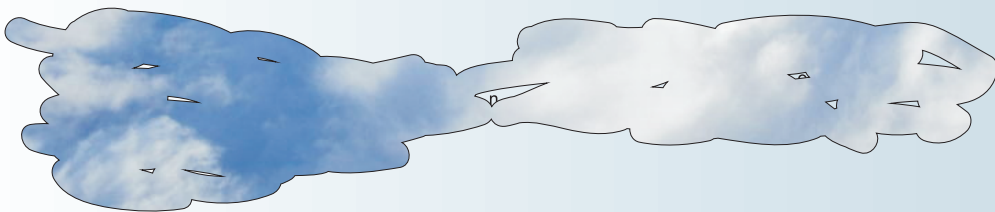

### WARNING

An R/C model airplane is not a toy and is not suitable for flyer under 14 years old.  
Read the instructions carefully before any use.  
If you are a beginner, it is necessary to let an experienced airplane pilot assist you.

## WARNING

1. Do not fly near houses or buildings, children's play areas, road traffic, railways and airports. Do not fly over people, power lines and pylons.
2. The ideal location for flying is a wide-open space in four directions with no people. (If using a model airfield, be sure to contact the airfield's administrator for permission.)
3. The battery should not be overcharged or put on the flammable material or near flammable material when it is being charged.
4. Always check that other pilots are not using the same frequency (band) in the same area before flight and make sure that you are flying in a safe area.
5. Do not fly in the strong winds.
6. Do not try to catch the plane when it is flying.
7. The children who are younger than 14 years old should be assisted by an experienced adult to fly the plane.
8. This model aircraft is designed to be powered by an electric motor. Flying this model aggressively may lead to serious accidents or injuries.
9. Do not touch the propeller when the motor is running, it could lead to serious injuries.

Note: SKY FLIGHT HOBBY CO., LTD  
will not take any responsibility for damage or accident caused by the  
improper use of this model.



Thank you for purchasing Sky Flight Hobby's SR-71 Electric R/C airplane. SR-71 is an electric ducted fan jet which is ideal for the intermediate or advanced flyer. In order to fly SR-71, please make sure you read through the instructions carefully before attempting to operate the model for the first time. You alone are responsible for the safe operation of your radio-controlled model. Young people should only be permitted to operate this model under the instruction and supervision of an adult who is aware of hazards involved in this activity. Please keep these operating instructions in a safe place. If you ever dispose of this model, be sure to pass the instructions on to the new owner. If you have any questions regarding the safe operation of your R/C model aircraft, please contact your local model shop for professional advice. Radio-controlled models are very demanding and potentially dangerous machines, and call for a high level of technical knowledge and skill from the operator, together with a responsible attitude. Please always keep this instruction manual ready at hand for quick reference, even after completing the assembly.





**Features:**  
 Powerful Electric Ducted Fan Jets;  
 High speed at about 100km/h;  
 Perfect aerobatic maneuvers, such as rolls, loops,  
 and the “Cobra Maneuvers”;  
 Stable invert flight;  
 Excellent hedgehopping performance;  
 Excellent stability of nosing up and down;  
 Controllable nose landing gear, easy to fly;  
 Die-cast design, easy to replace the spare parts.

**Description:**  
 Length: 1200 mm  
 Wingspan: 700 mm  
 Wing Area: 24.5 dm<sup>2</sup>  
 Flying weight: 1050g  
 EDF Diametre: 64mm×2  
 Thrust: ≥ 1200g

6CH RC  
 2×30A brushless ESC  
 Five 9gram servos  
 2×4300KV brushless motor  
 2200mAh /11.1V 20C Li-Po battery  
 Charger

## Contents of Kits (Part List)

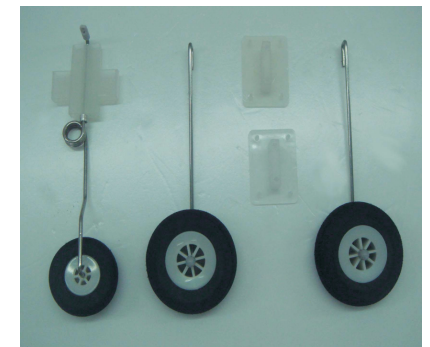
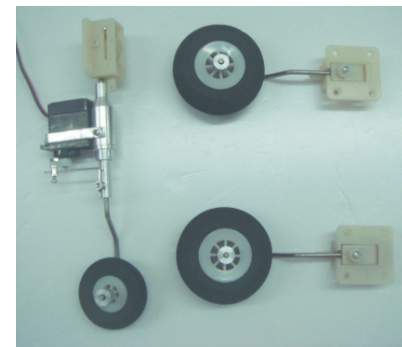

# Assembly

## 1. Fuselage installation

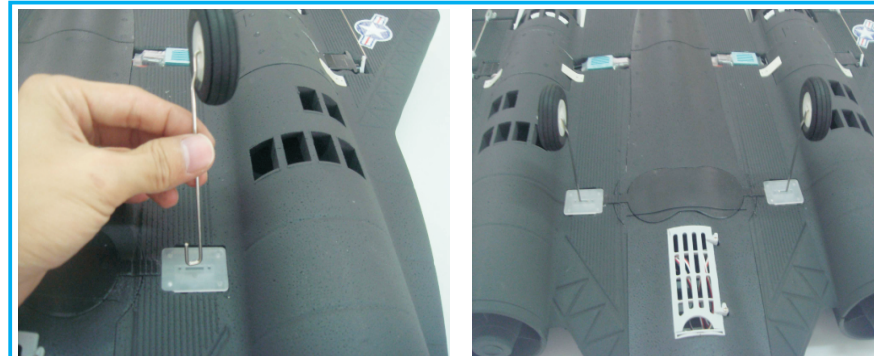
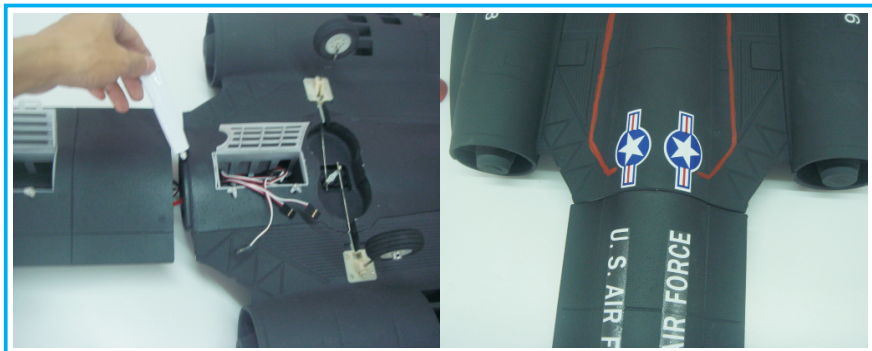

## 2. Landing gear installation

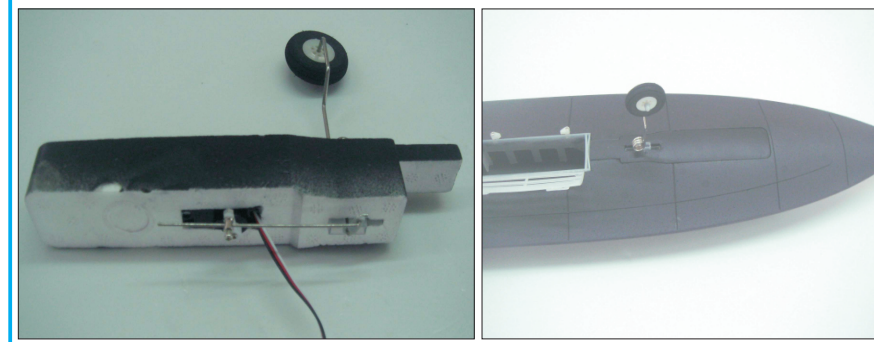
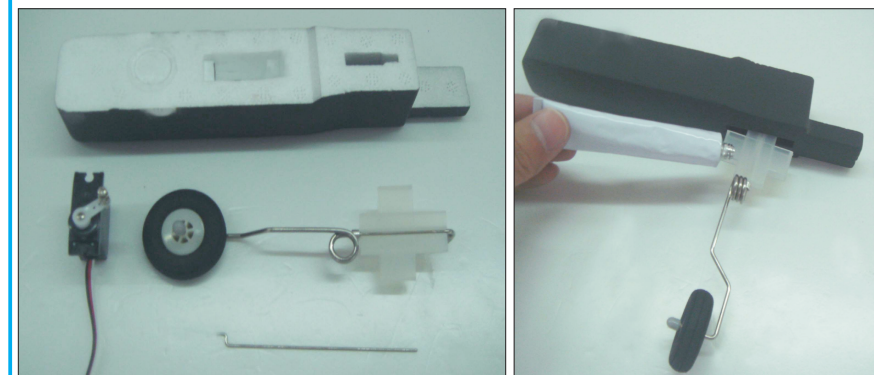
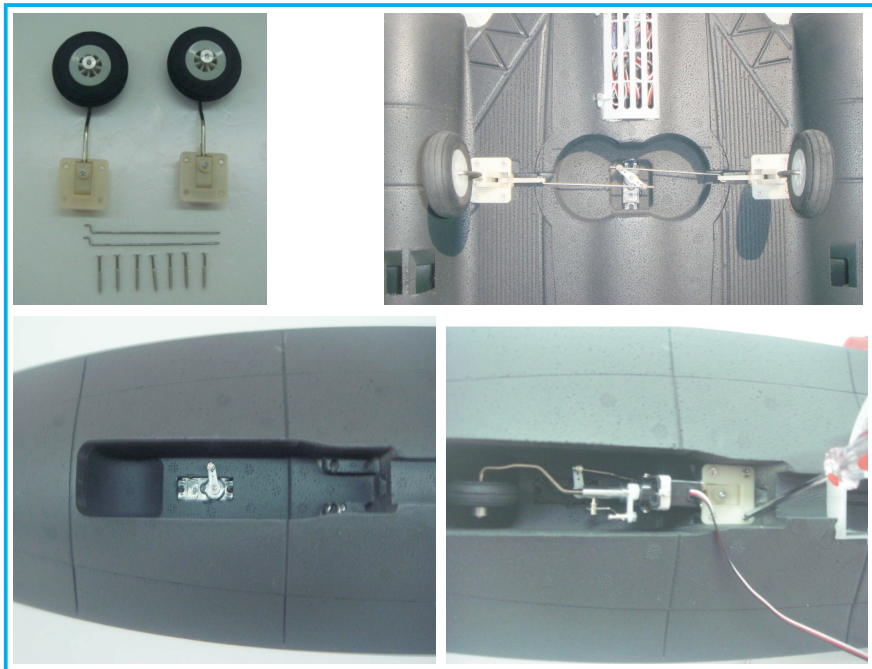



3. Vertical tail installation



4. Nose cone installation

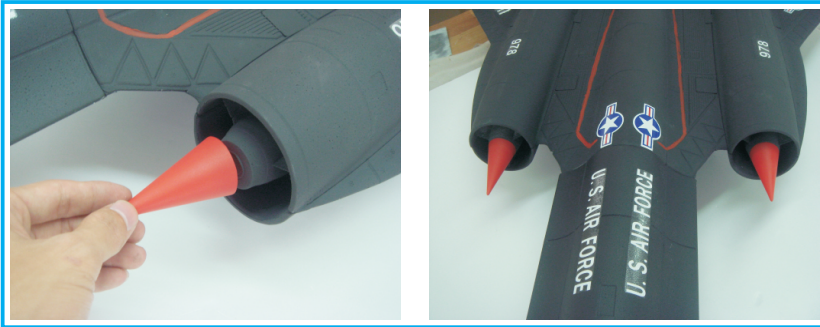

5. Electronic equipment installation

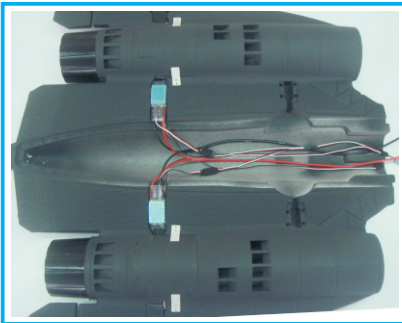

6. above the elevator for 3°

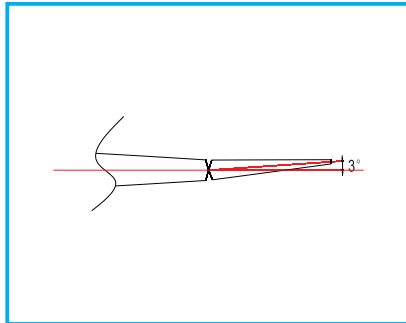

7. The place of red adhesive sticker is

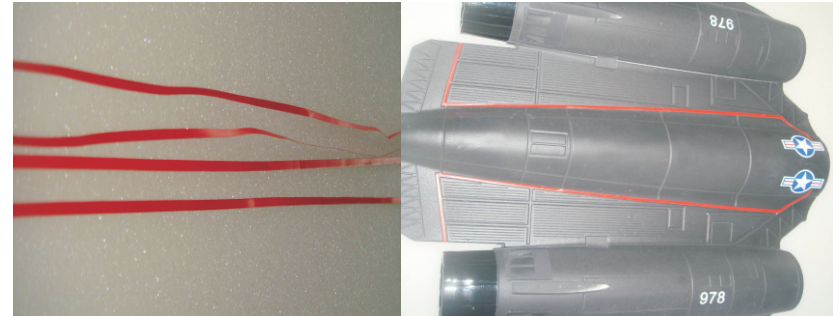

8. Installation finished:



Center of gravity

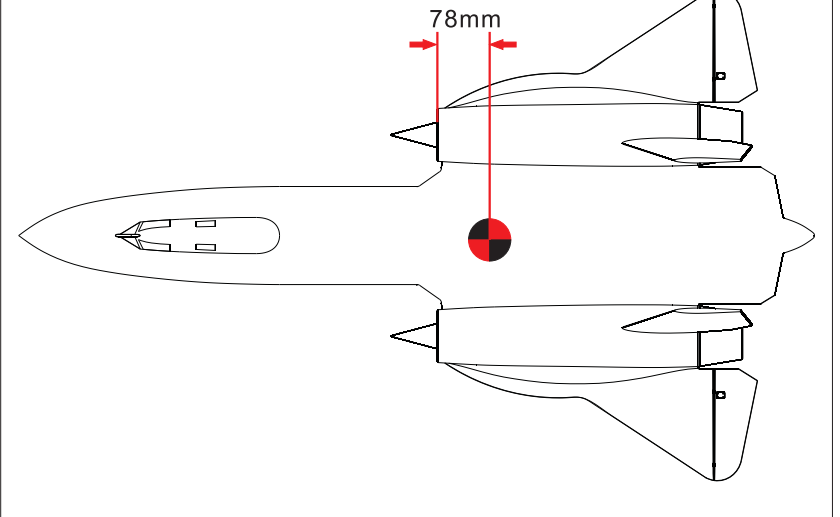

## Problem Solving

### Pre-Flight Check

1. Check carefully that every part of the plane is installed properly.
2. Always check that there are no other pilots using the same frequency (band) in the same area.
3. Please switch on the power of the transmitter before connecting the battery. Make sure that the battery is fully charged.
4. Check that the plane responds properly to the control signals.
5. Extend the transmitter antenna all the way and test the range of the radio signal. With the transmitter and model switched on, step back around 20m and test the interference. If there is no interference, the plane is ready to fly.

### Tips:

1. Train yourself in the FMS (Flight Model Simulator) before you fly Sky Flight Hobby's SR-71 Electric R/C airplane. It will help you with coordination when you fly your model.
2. Fly SR-71 at low speed on the ground to learn the direction control of the plane. Please remember: when the plane flies towards you, it means that the direction control is reversed.
3. Flying with the assistance of an experienced flyer will help your first-time flight.
4. Do not fly in the strong wind.
5. Always face the wind when take-off and landing.
6. Do not fly the plane across your head which may lead to disorientation. Please always fly the plane in front of you but never behind.
7. Please consider purchasing a spare battery pack for longer flights.
8. Do not fly this plane with some parts damaged or broken. This may result in accidents or injuries. Please contact our local dealer for spare parts to replace.

Phenomenon	Typical error	Problem solving
Motor do not work	The battery is not full charged	Charge the battery
	The battery of the transmitter is in low power.	Replace the battery in the transmitter.
	There is some broken circuit in the plane	Contact your local dealer
Can not fly in a line	The rudder is not in the center of the fuselage	Adjust the trim on the transmitter.
	The main wing is not installed in the center.	Reassemble the main wing.
	The nose landing gear is twisted.	Verify the nose landing gear.
Can not climb	The battery is not fully charged.	Charge the battery.
	Elevator is tilted downward.	Adjust the trim on the transmitter.
Short control distance	The battery of the transmitter is in low power.	Replace the battery of transmitter.
	The antenna is not fully extended.	Extend the antenna fully.