

Instruction Manual



WARNING

An R/C model airplane is not a toy and is not suitable for flyer under 14 years old.
Read the instructions carefully before any use.
If you are a beginner, it is necessary to let an experienced airplane pilot assist you.

WARNING

1. Do not fly near house, buildings, children play areas, road traffic, rail ways and airports. Do not fly over people, power lines and pylons.
2. An ideal location for flying is a wide-open space in four directions with no people that could defer flying. (If using a model airfield, be sure to contact the airfield's)
3. The battery should not be overcharged or put on the flammable material or near flammable material when it is being charged.
4. Always check that other pilots are not using the same frequency(band) in the same area before flight and make sure that you are flying in a safe area.
5. Do not fly in conditions that can impair your flight, i.e. : strong winds.
6. Do not try to catch the plane when it is flying.
7. The children who are younger than 14 years of age should be under the supervision of an experienced pilot, parent or guardian. Be prepared to take over if they are still new to fly.
8. This model aircraft is designed to be powered by an electric motor. Flying this model aggressively may lead to serious accidents or injuries.
9. Do not touch the propeller when the motor is running, it will lead to serious injuries.

Note:
SKY FLIGHT HOBBY CO., LTD
will not take any responsibility for damage or accident caused by the improper use of this model.

Thank you for purchasing F-35.

The F-35 is an electric ductedfan jet which is ideal for the intermediate or advanced Flyer.

In order to fly the F-16, please make sure you read through the instructions carefully before attempting to operate the model for the first time.

You alone are responsible for the safety, and the safe operation of your radio-controlled model. Young pilots should fly the models under the supervision of adults, or experienced pilots who are aware of the potential hazards.

Please keep these operating instructions in a safe place. If you ever sell, trade, or dispose of this model in any manner, please pass on the instructions to the new owner.

If you have any questions in regarding to the safe operation, or possible precautions please call your local hobby shop for professional advice.

Radio-controlled models are very demanding and potentially dangerous machines. They call for a high level of technical knowledge and skill from the operator. Please always keep this instruction manual ready at hand for quick reference, even after completing the assembly.



Description:

Length: 1185mm
Flying weight: 1200g
Wingspan: 850mm
EDF Diametre: 70mm
Thrust: ≥1300g

The kits include:

8CH RC
50A brushless ESC w/ 5A UBEC
thirteen 9gram servos
2400KV brushless motor
2200mAh /18.5V 20C Li-Po
battery



Brushless motor and ESC installation: 1-12th pictures

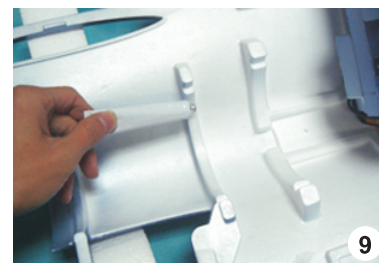
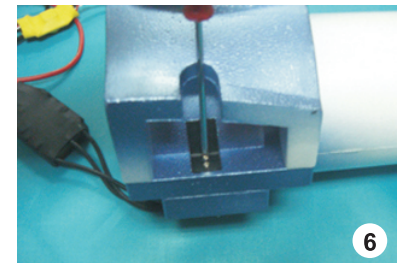
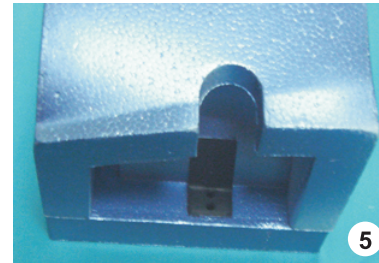
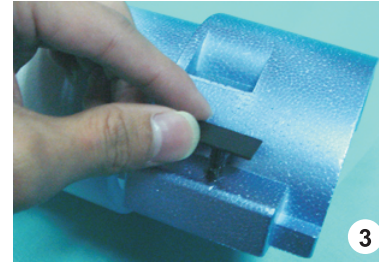
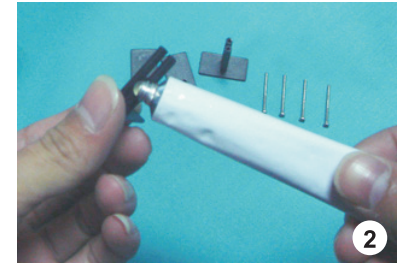
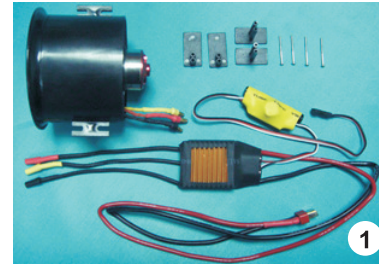

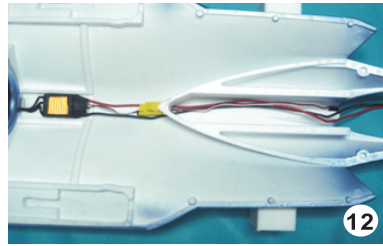
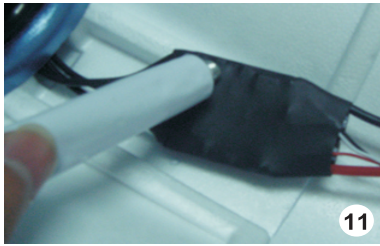

Bomb installation(13-29th pictures) : need 1 servo with 300mm wire. please refer to 24th pictures

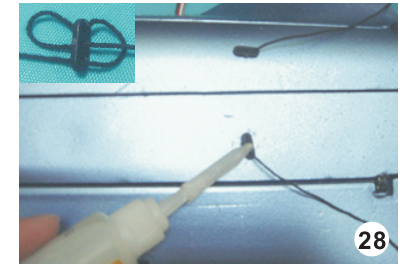
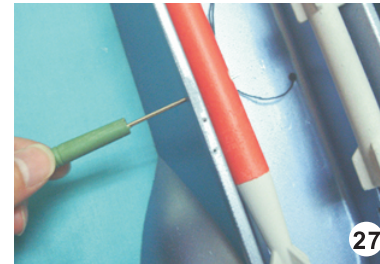
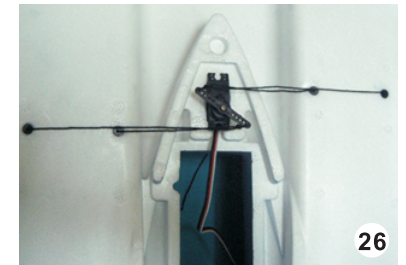
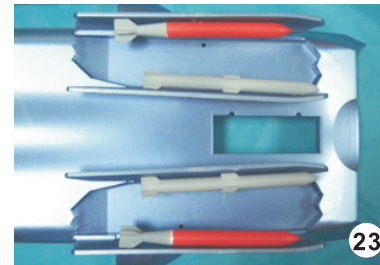
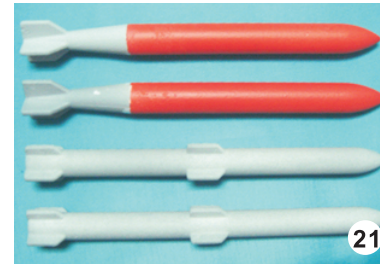
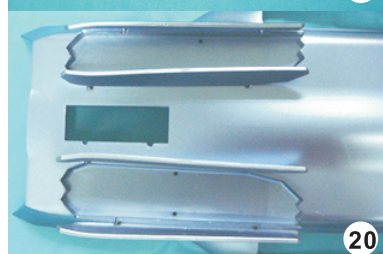
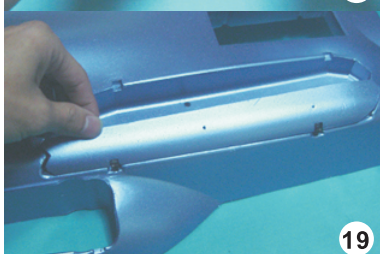
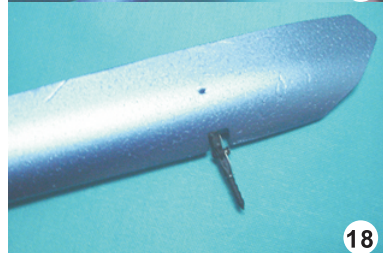
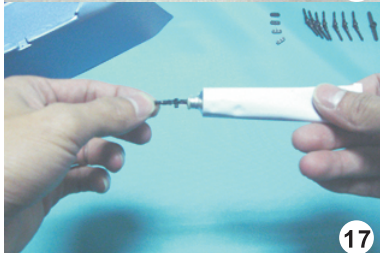
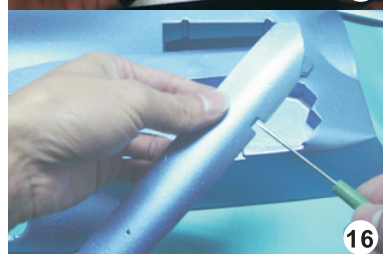
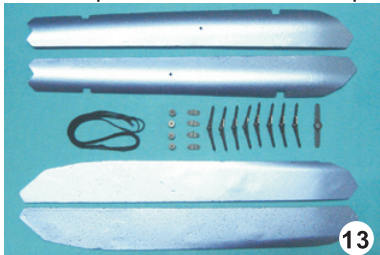

Battery box installation:30-33rd pictures
Servos installation:34-43rd pictures (6 servos with 800mm wires needed:2 pcs circles for controlling Aileron, 2 pcs for controlling 2 pcs servos,2 pcs for controlling vector vents)

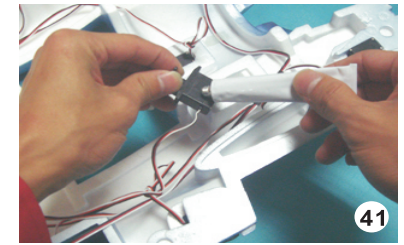
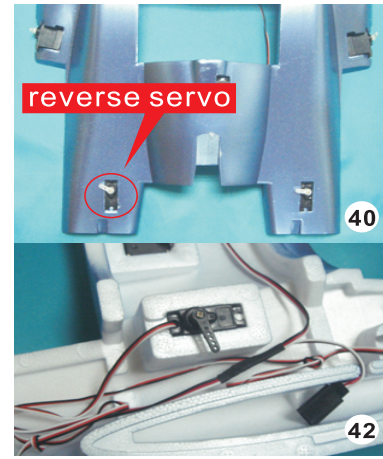
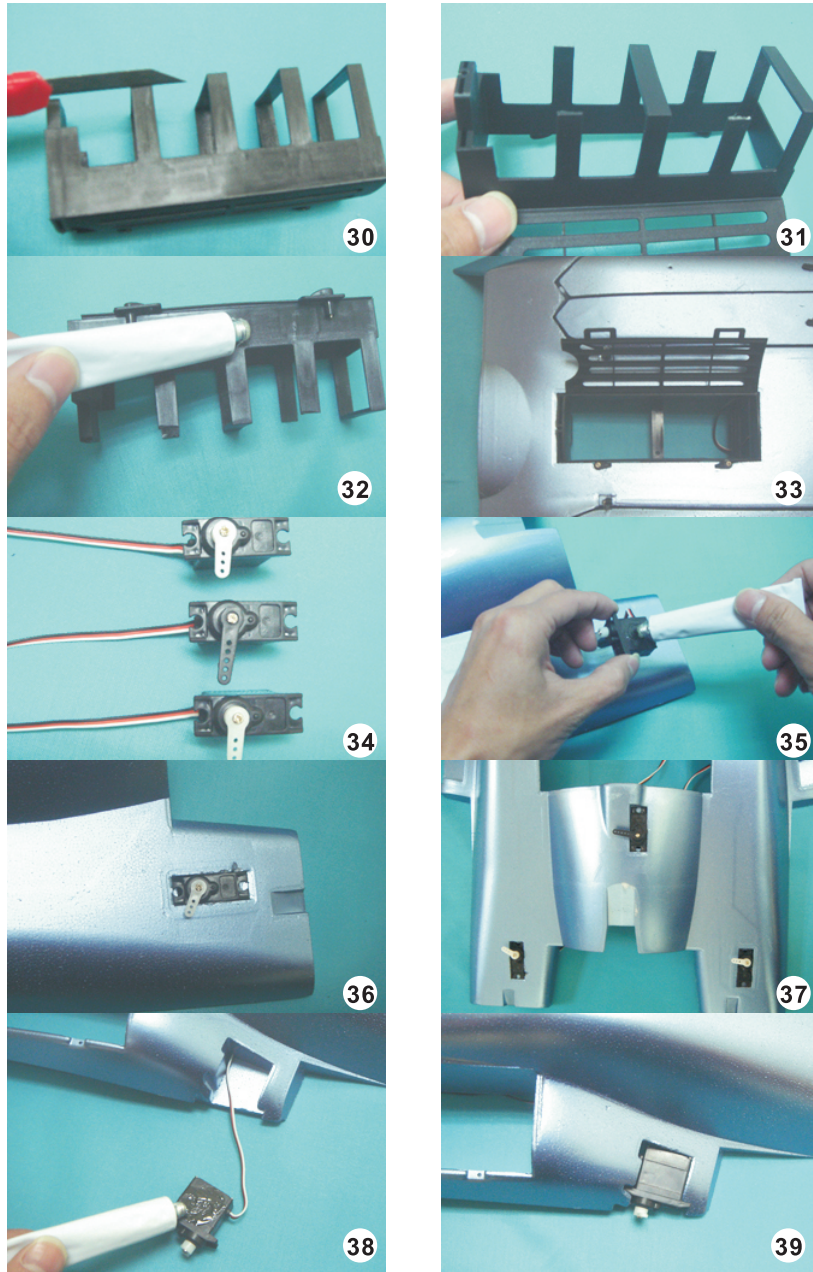

Verticla tail wires installation (please refer to 43rd picture)

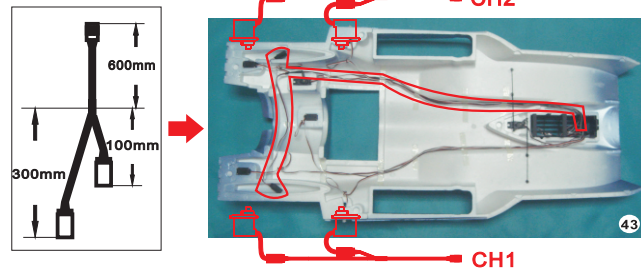

Retracts installation (44-55th pictures): need 2 servos with 500mm wire and 1 reverse servo with 500mm wire

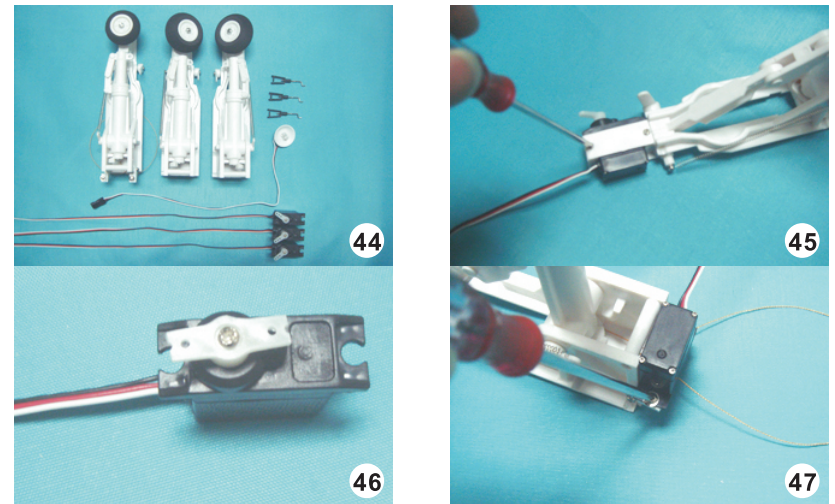

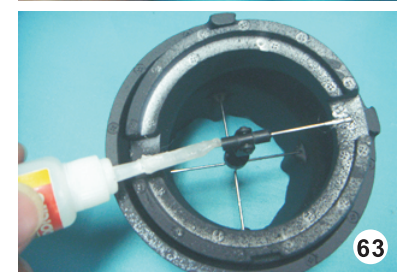
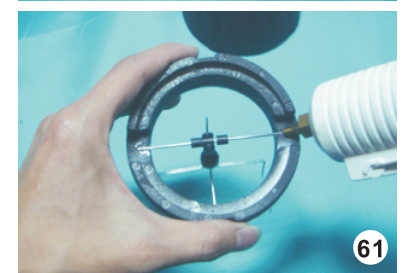
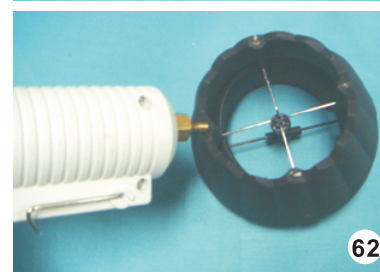
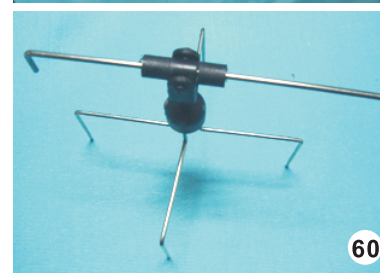
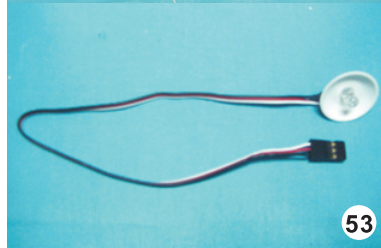
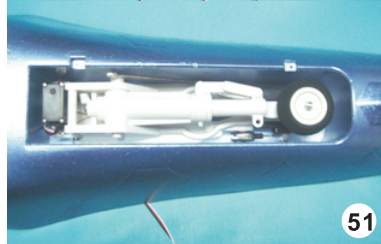
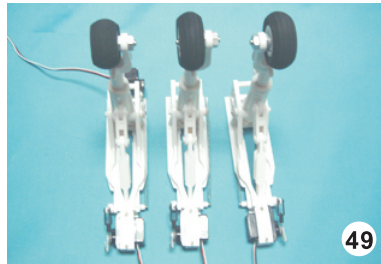
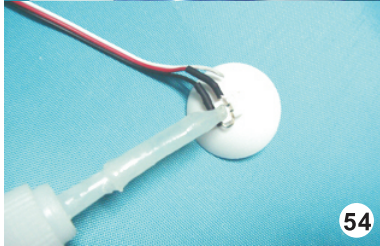
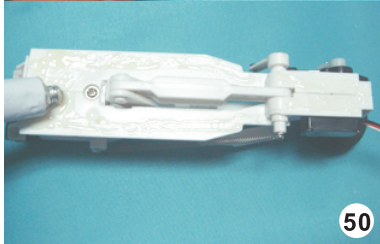
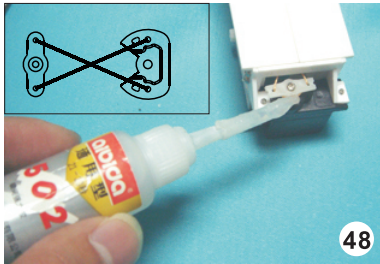

Stick kits body(56-58th pictures)
Vectors vents installation(59-73rd pictures)

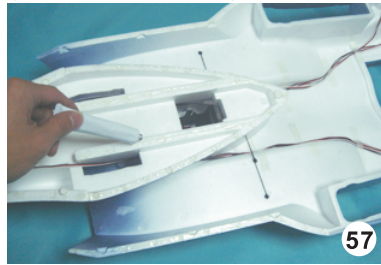
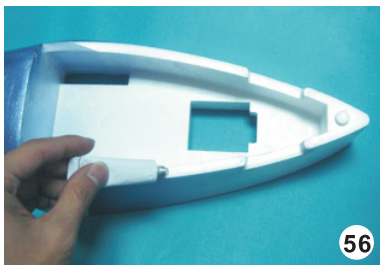

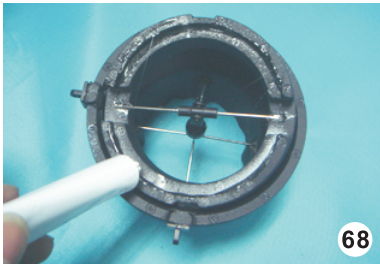

68

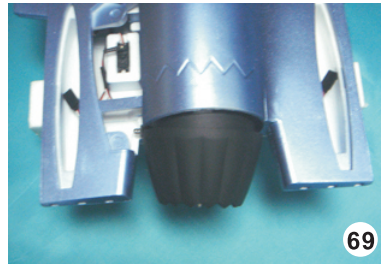

69

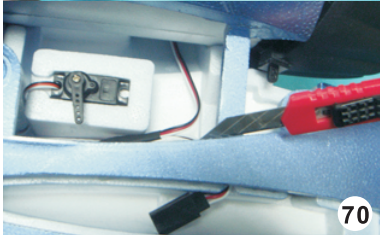

70

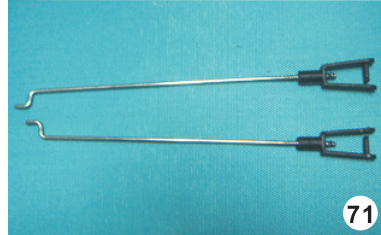

71



72

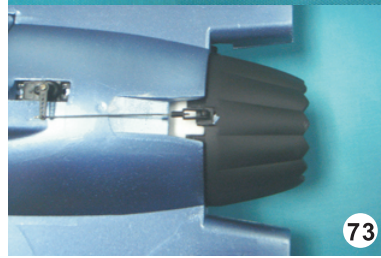

73

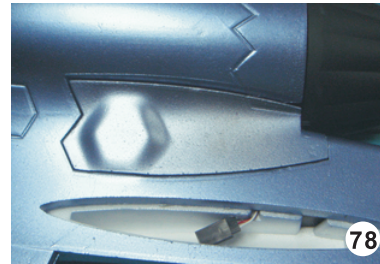

78

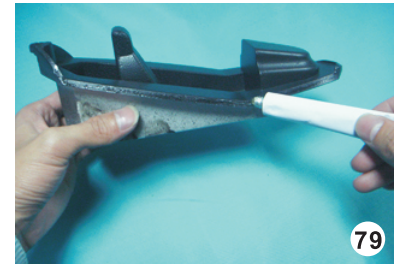

79



80

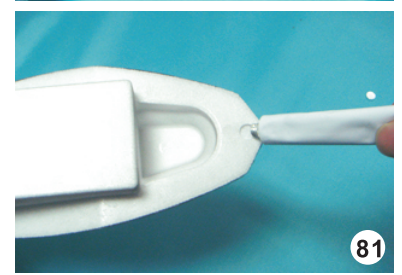

81



82



83

cockpit cover and one canopy installation(74-84th pictures)



74



75



76



77

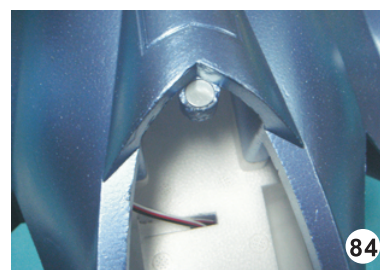

84

Retracts cover installation (85-93rd pictures)



85

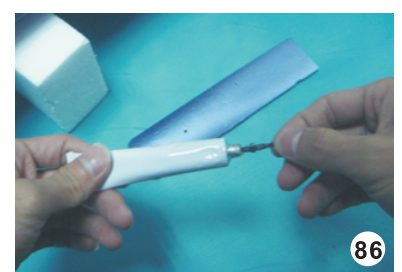

86

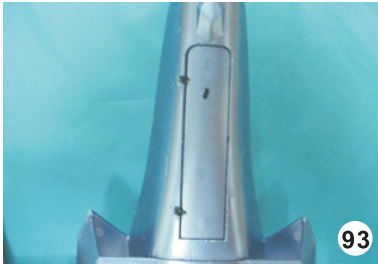
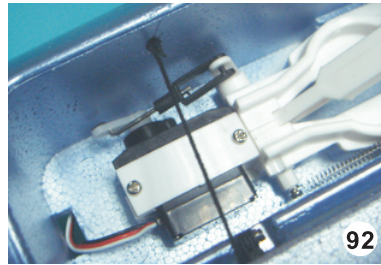
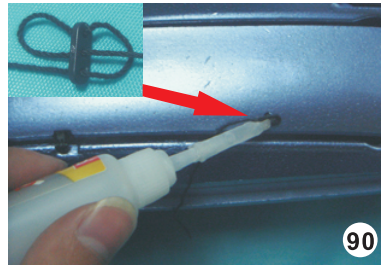
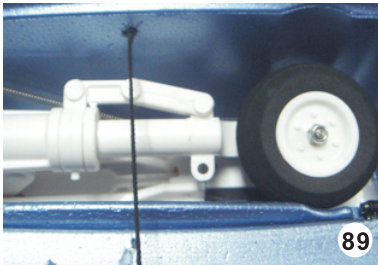
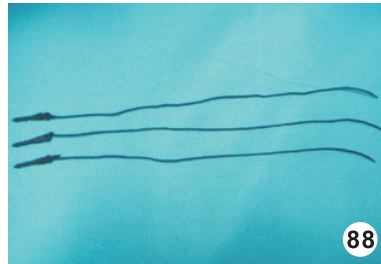
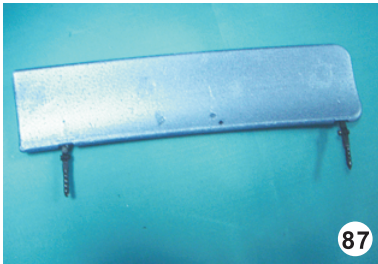

Vertical tail installation
(94-99th pictures)

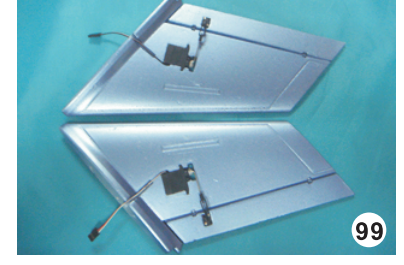
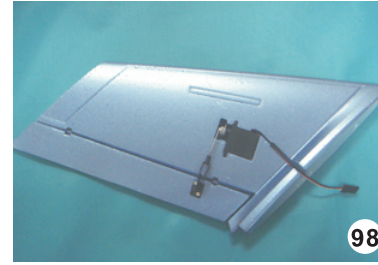
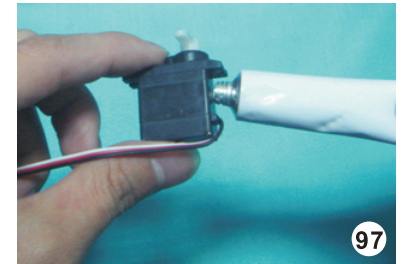
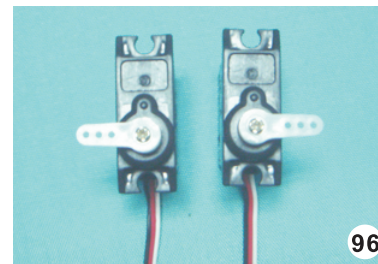
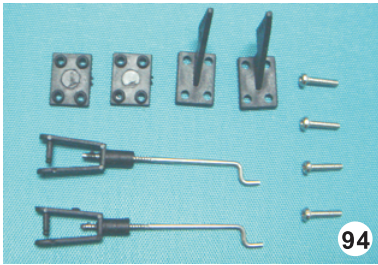

Horizontal tail installation(100-108th pictures)

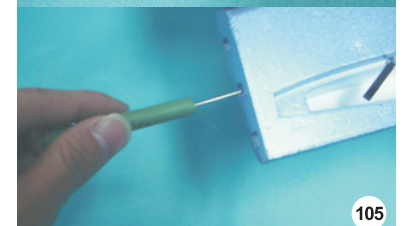
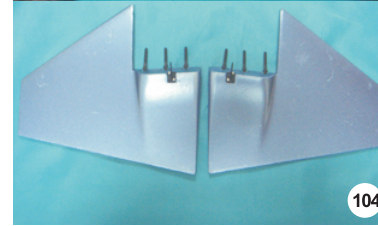
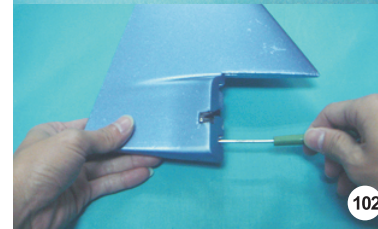
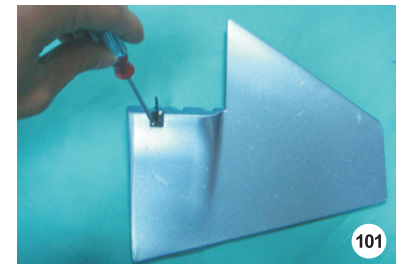
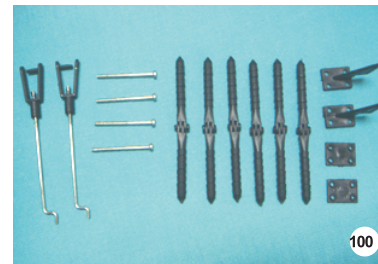

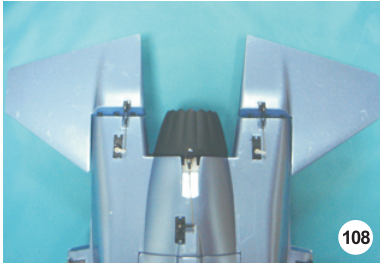
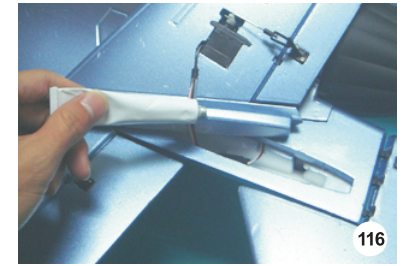
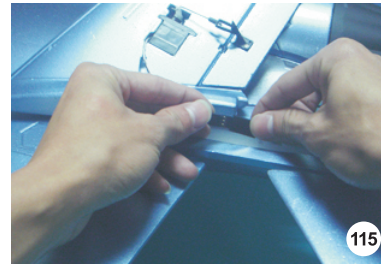
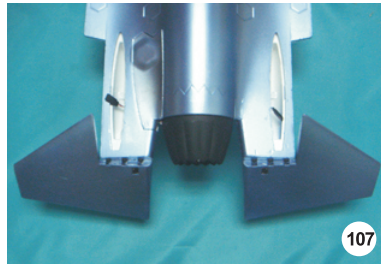
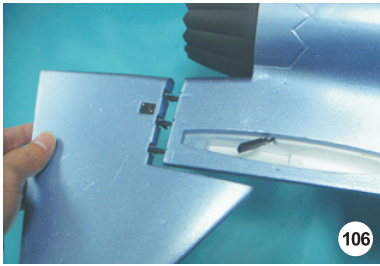

Aileron installation(109-114th pictures)
Vertical tail and body connection
(115-117th pictures)

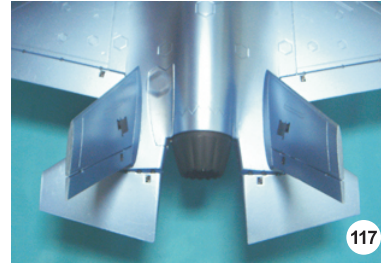

Hood and antenna installation
(118-119th pictures)
Stick water stickers(120-125th pictures)

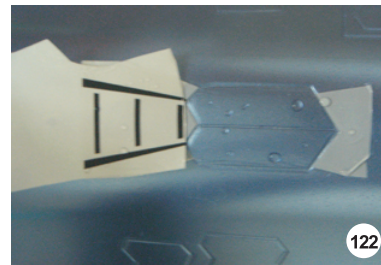
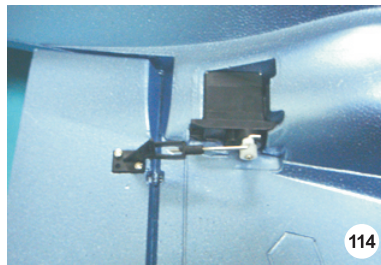
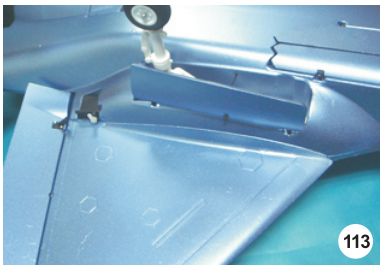
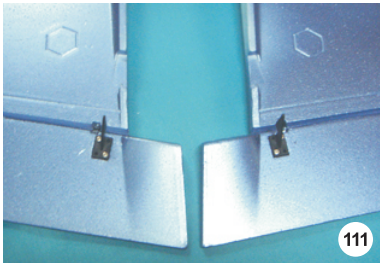
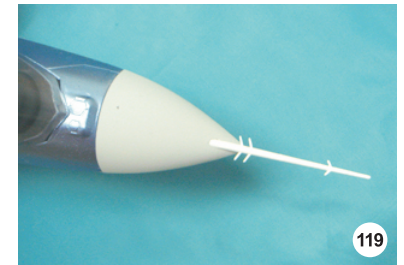
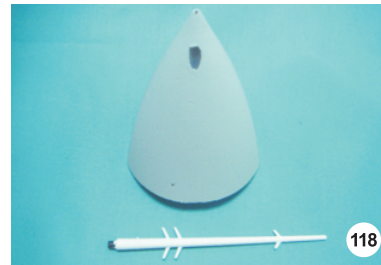
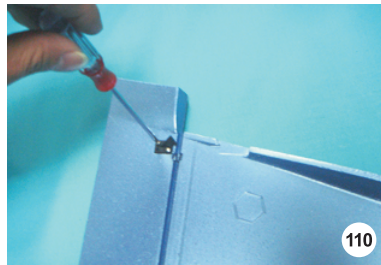
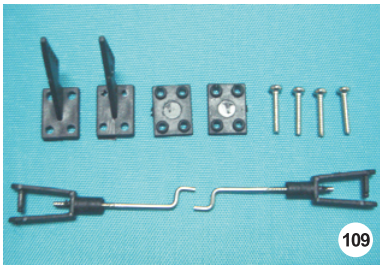



124



125

Receiver and battery installation(126-131st pictures)



126

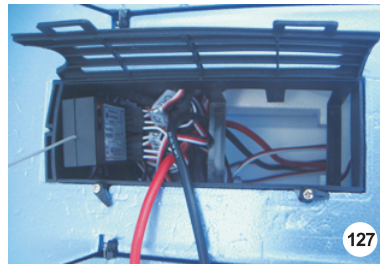

127

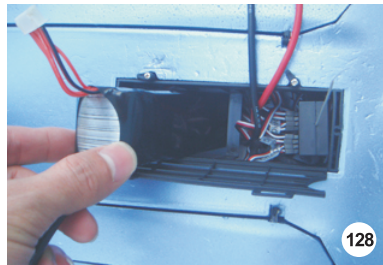

128



129



130

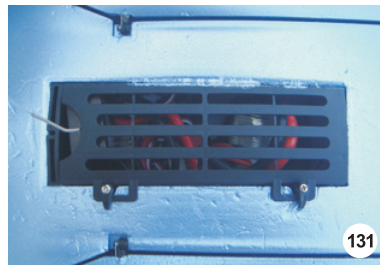

131

F-35 Pre-Flight Check

1. Check carefully that every part of the plane is installed properly.
2. Always check that there are no other pilots using the same frequency in the same area.
3. Please switch on the power of the transmitter before connecting the battery. Make sure that the battery is fully charged.
4. Check that the plane responds properly to the control signals.
5. Extend the transmitter antenna all the way and test the range of the radio signal. With the transmitter and model switched on, step back around 20m and test the interference. If there is no interference, the plane is ready to fly.

Problem Solving

Phenomenon	Typical error	Problem solving
Motor do not work	The battery is not full charged The battery of the transmitter is in low power. There is some broken circuit in the plane	Charge the battery Replace the battery in the transmitter. Contact your local dealer
Can not fly in a line	The rudder is not in the center of the fuselage The main wing is not installed in the center. The nose landing gear is twisted.	Adjust the trim on the transmitter. Reassemble the main wing. Verify the nose landing gear.
Can not climb	The battery is not fully charged. Elevator is tilted downward.	Charge the battery. Adjust the trim on the transmitter.
Short control distance	The battery of the transmitter is in low power. The antenna is not fully extended.	Replace the battery of transmitter. Extend the antenna fully.

